



Optoelektronické snímače W12-2 Laser, Jednocestná světelná závora

WS/WE12L-2P430



Typ > [WS/WE12L-2P430](#)
Obj. číslo > [1018254](#)



At a glance

- Laser protection class 1 or 2
- Large sensing range and high levels of operating reserve
- Rugged sensors for industrial use
- Highly visible laser light spot for varying object detection
- Rugged die-cast zinc housing with optional Teflon® coating
- Versatile mounting options due to dovetail mounting - mounting holes and oblong holes
- Highly visible status LEDs
- Adjustable sensing range

Your benefits

High immunity to optical interference provides reliable object detection, large sensing ranges and high reserve levels

Highly visible laser light spot enables quick sensor alignment, excellent switching characteristics and high-quality detection

Rugged metal housing (optional Teflon® coating available) requires less maintenance due to its resistance to high-pressure cleaning environments

Highly visible status LEDs simplify commissioning and reduce installation time

Laser protection class 1 or 2 for eye safety

Easy installation using SICK accessories



!Features!

Rozměry (Š x V x H):	15 mm x 49 mm x 41,5 mm
Rozměr světelné stopy max.:	0 m ... 80 m
Housing design (light emission):	Kvádrový
Vysílač světla:	Laser ¹⁾
Druh světla:	Viditelné červené světlo
Vlnová délka:	650 nm
Princip senzoru/detekce:	Jednocestná světelná závora
Světelné stopy (vzdálenost):	150 mm (60 m)

¹⁾ Average service life 50,000 h at Ta = +25 °C

!Mechanics/electronics!

Krytí:	IP 67 IP 69K
Napájecí napětí:	10 V DC ... 30 V DC ¹⁾
Zbytkové vlnění:	$\leq 5 V_{SS}$ ²⁾
Spínací výstup:	PNP, Selectable via L/D control wire
Výstupní proud I _{max.} :	100 mA
Doba odezvy:	$\leq 200 \mu s$ ³⁾
Switching frequency:	2.500 Hz ⁴⁾
Způsob připojení:	Connector M12, 4-pin
Třída ochrany:	II
Ochranné okruhy:::	A C ^{5) 6) 7)} D
Hmotnost:	260 g
Teplota okolí provoz:	-10 °C ... 50 °C
Teplota okolí sklad:	-25 °C ... 75 °C
Napětí signálu NPN HIGH/LOW:	$U_v - < 2,9 V, U_v V/0 V \leq 1,5 V$
Napětí signálu PNP HIGH/LOW:	$U_v - < 2,9 V, U_v V/0 V \leq 1,5 V$
Odběr proudu, Vysílač:	$\leq 45 mA$ ⁸⁾
Odběr proudu, přijímač:	$\leq 15 mA$ ⁹⁾
UL File-No.:	UL No. NRKH.E181493, CDRH-Konform (0312012-00)

¹⁾ Hranicní hodnoty ²⁾ May not exceed or fall short of V_S ³⁾ Cas postupu signálu pri ohmické záteži ⁴⁾ Pri pomeru svetlo/tma 1:1 ⁵⁾ A = V_S connections reverse-polarity protected ⁶⁾ C = interference suppression ⁷⁾ D = outputs overcurrent and short-circuit protected ^{8) 9)} Bez zatížení

Dimensional drawing

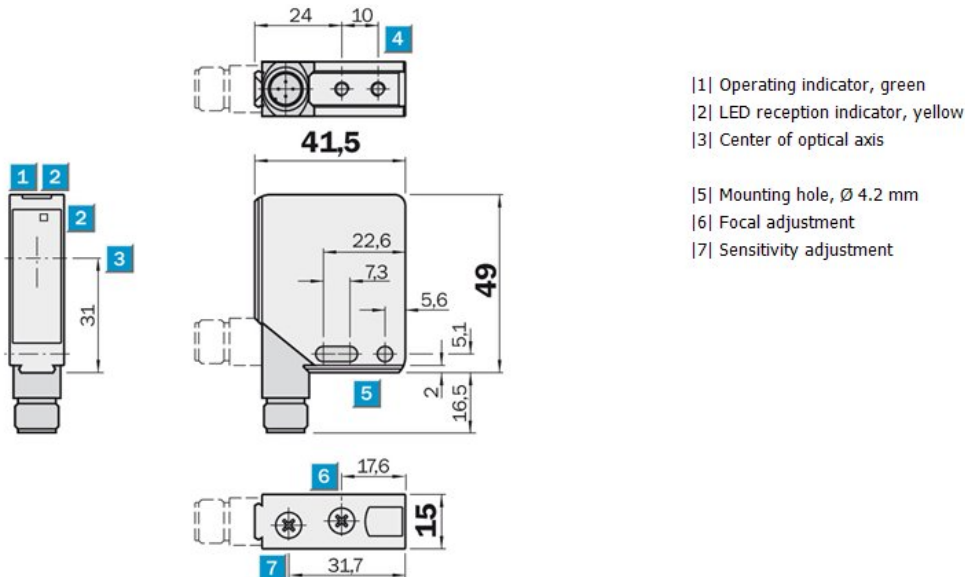

Einstell-Möglichkeiten

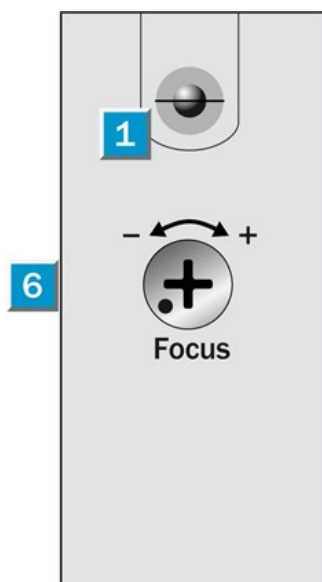

- |1| Operating indicator (WS above only)
- |6| Focal adjustment (WS)

Schéma zapojení



Schéma zapojení



Schéma zapojení

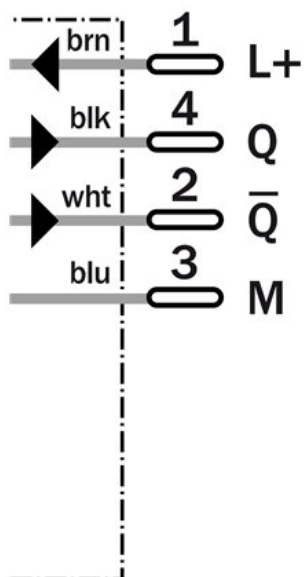

Connection type

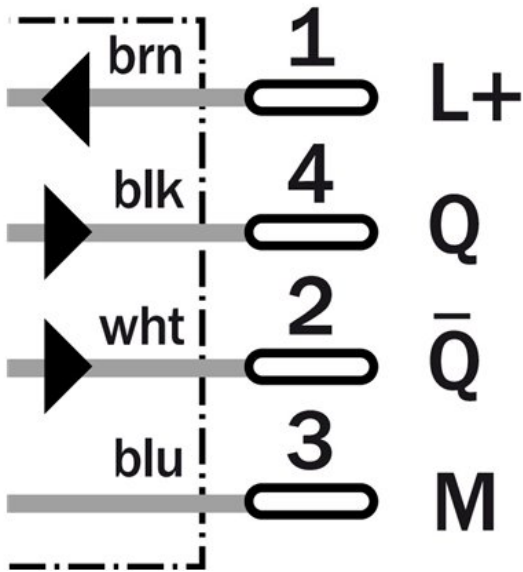
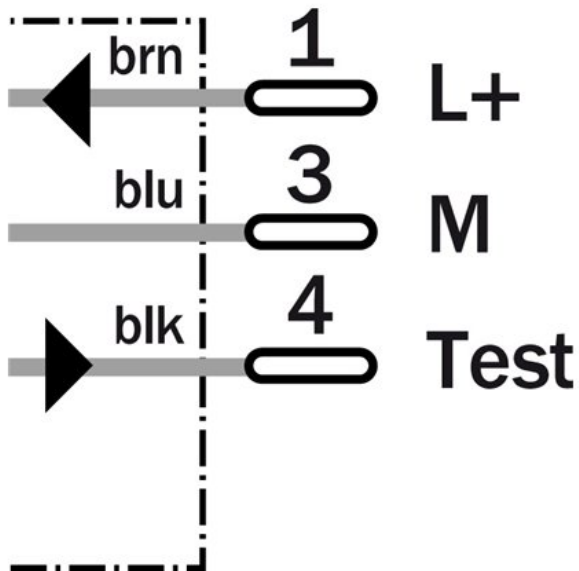
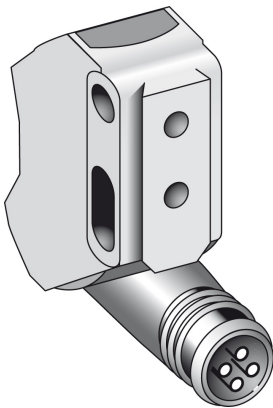

Charakteristika

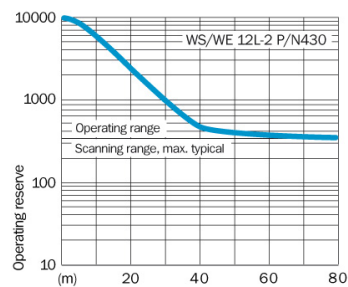

Sensing range diagram

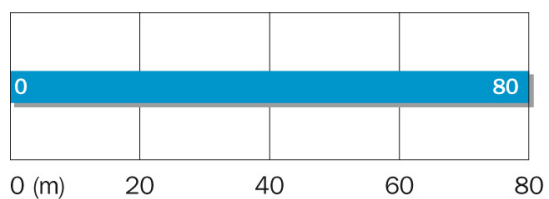

■ Betriebsreichweite/typ. max. Reichweite

Australia

Phone +61 3 9497 4100
1800 334 802 – tollfree
E-Mail sales@sick.com.au

Belgium/Luxembourg

Phone +32 (0)2 466 55 66
E-Mail info@sick.be

Brasil

Phone +55 11 3215-4900
E-Mail sac@sick.com.br

Canada

Phone +1(952) 941-6780
1 800-325-7425 – tollfree
E-Mail info@sickusa.com

Ceská Republika

Phone +420 2 57 91 18 50
E-Mail sick@sick.cz

China

Phone +852-2763 6966
E-Mail ghk@sick.com.hk

Danmark

Phone +45 45 82 64 00
E-Mail sick@sick.dk

Deutschland

Phone +49 211 5301-301
E-Mail kundenservice@sick.de

España

Phone +34 93 480 31 00
E-Mail info@sick.es

France

Phone +33 1 64 62 35 00
E-Mail info@sick.fr

Great Britain

Phone +44 (0)1727 831121
E-Mail info@sick.co.uk

India

Phone +91-22-4033 8333
E-Mail info@sick-india.com

Israel

Phone +972-4-999-0590
E-Mail info@sick-sensors.com

Italia

Phone +39 02 27 43 41
E-Mail info@sick.it

Japan

Phone +81 (0)3 3358 1341
E-Mail support@sick.jp

Magyarország

Phone +36 1 371 2680
E-Mail office@sick.hu

Nederlands

Phone +31 (0)30 229 25 44
E-Mail info@sick.nl

Norge

Phone +47 67 81 50 00
E-Mail austefjord@sick.no

Österreich

Phone +43 (0)22 36 62 28 8-0
E-Mail office@sick.at

Polska

Phone +48 22 837 40 50
E-Mail info@sick.pl

România

Phone +40 356 171 120
E-Mail office@sick.ro

Russia

Phone +7 495 775 05 30
E-Mail info@sick.ru

Schweiz

Phone +41 41 619 29 39
E-Mail contact@sick.ch

Singapore

Phone +65 6744 3732
E-Mail admin@sicksgp.com.sg

South Africa

Phone +27 11 472 3733
E-Mail info@sickautomation.co.za

South Korea

Phone +82-2 786 6321/4
E-Mail info@sickkorea.net

Slovenija

Phone +386 (0)1-47 69 990
E-Mail office@sick.si

Suomi

Phone +358-9-25 15 800
E-Mail sick@sick.fi

Sverige

Phone +46 10 110 10 00
E-Mail info@sick.se

Taiwan

Phone +886 2 2375-6288
E-Mail sales@sick.com.tw

Türkiye

Phone +90 216 528 50 00
E-Mail info@sick.com.tr

United Arab Emirates

Phone +971 4 8865 878
E-Mail info@sick.ae

USA/México

Phone +1(952) 941-6780
1 800-325-7425 – tollfree
E-Mail info@sickusa.com

More representatives and agencies
at www.sick.com